

# Apple iPhone/iPad

1. Connect to a Belmont Wi-Fi network.
2. Print from a document or app.
3. Adjust Printer Options.
4. Pick up printing.



BruinPrint requires a connection to a Belmont wireless network.

## 1. Connect to Belmont Wi-Fi Network.

- a. Tap the **Settings** app on your device.
- b. Tap **Wi-Fi** and then tap **Belmont or RESNET**.
- c. A checkmark will indicate a successful connection.

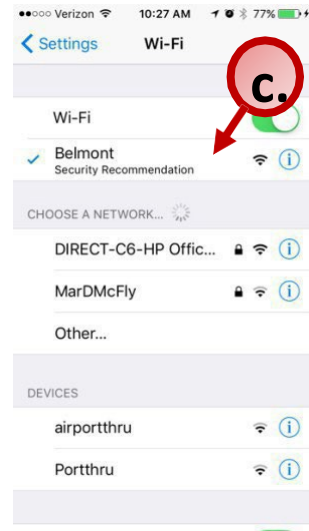
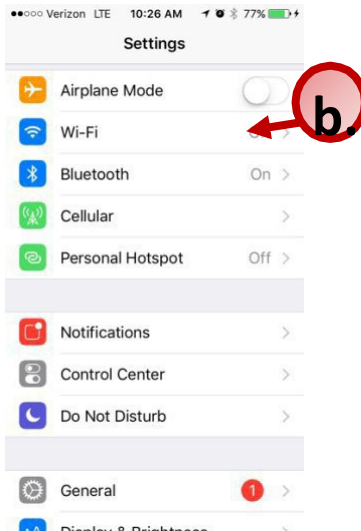
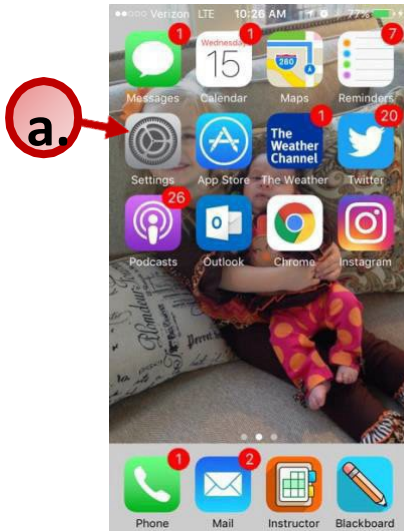

## 2. Print from a document or app.

- a. Within a document or app, tap the **Action (Share)** or the **Menu** icon.
- b. A pop-up menu will appear. Tap **Print**.

**EXAMPLE:** Print from Document (i.e., Excel)

**EXAMPLE:** Print from App (i.e., Google Drive)

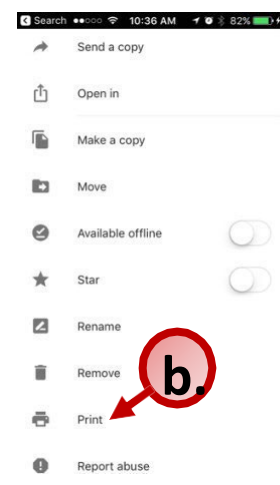
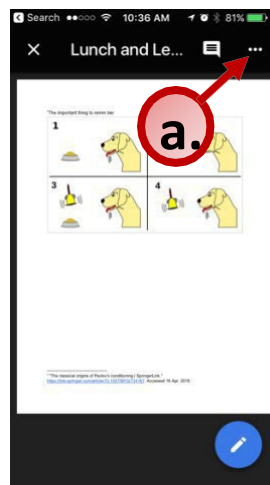
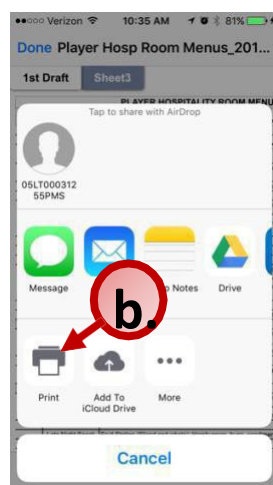

### 3. Adjust Printer Options.

- a. Tap **Select Printer**
- b. Tap **bruinprint**.
- c. Type your BruinPrint username (**i.e., Belmont email address**).
- d. Type your BruinPrint password (**i.e., Belmont email password**).
- e. Tap **OK** (password box will disappear).
- f. Edit number of copies.
- g. Adjust advanced printing options (e.g., two-sided,color)
  - i. **Please be aware of your default settings – some devices are defaulted to COLOR PRINT.**
  - ii. **Do not use A3 or A4 paper sizes. Use Letter size instead.**
- h. Tap the **Print** button in the upper-right corner.

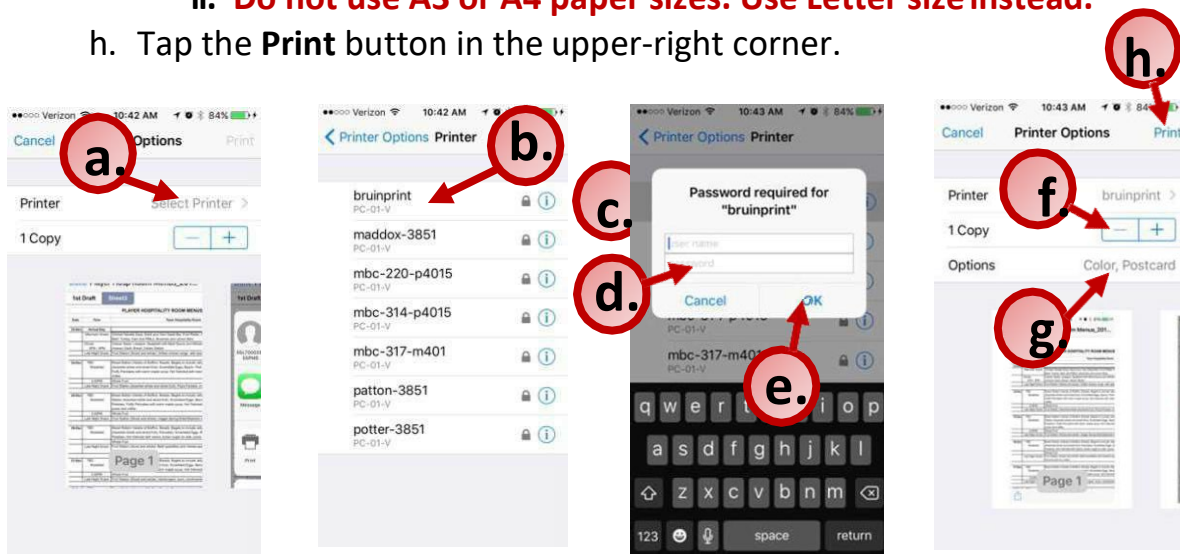

#### 4. Pick up printing.

- a. Walk to a BruinPrint station.
- b. Tap your BUID card or mobile wallet on the card reader.
- c. Click Print Release.
- d. The display screen will list current printings.
- e. Tap the document you want to print.
- f. Tap the **Print** button on the bottom-right corner of the displayscreen.
- g. Once the document is printed, tap the **Log Out** button at the top-right corner of the display screen.